

Perforated acoustic panel is a kind of resonance absorption material with holes through on the MDF board. It has strong selection on the sound spectrum and particular great performance on the middle and low frequency. It has better sound absorption effect on medium and high frequency if there is sound absorption cotton filled at the back side cavity. The holes diametr and pitch can be custom made.

Perforated acoustic panel is made of high quality MDF board and has outstanding envirlnmental, fireproof and waterproof performance. The various colors and finish choices can satisfy all customers' acoustic and decoration requirements. Compare with the groove wood acoustic panel, it has better impact against effect. The highest fire retardant grade can reach A2(GB) grade, and the best environmental protection can reach E1(GB) grade.

Model description:

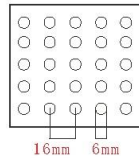
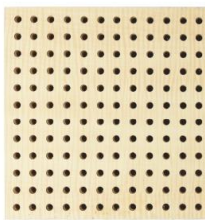

型号: 直通孔E16/6 型
Item:Hole through E16/6
穿孔率12.5%
Peforated rate 12.5%

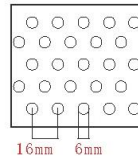

型号: 直通孔V16/6 型
Item:Hole through V16/6
穿孔率12%
Peforated rate 12%

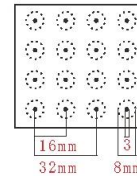
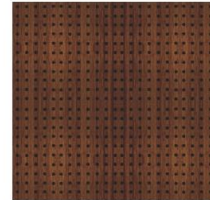

型号: 大小孔E16/3-10 型
Item:Big and small hole E16/3-10
穿孔率2.8%
Peforated rate2.8%

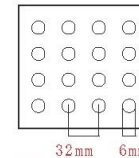
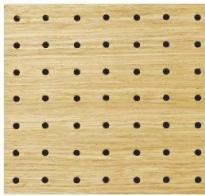

型号: 直通孔E32/6 型
Item:Hole through E32/6
穿孔率4.2%
Peforated rate 4.2%

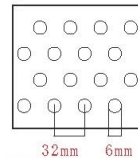

型号: 直通孔V32/6 型
Item:Hole through V32/6
穿孔率4%
Peforated rate 4%

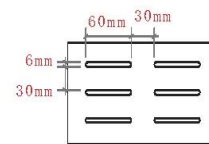

型号: U型孔60-30-6
Item:U Shape Hole 60-30-6
穿孔率9.2%
Peforated rate9.2%

Basic materials:



Standard MDF



Eco-friendly MDF



Fireproof MDF



MDF+ magnesium oxide board+ MDF



MDF+ magnesium oxide board+ MDF
+ magnesium oxide board+ MDF

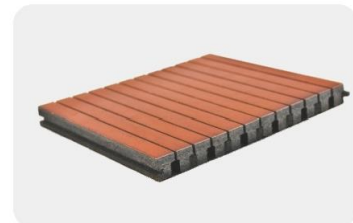

Carbon fiber board

Acoustic performance:

测试条件
TEST CONDITION

A、15mm孔木吸音板 B、填充50厚32kg/m³吸声棉 C、50mm空腔
A. 15mm thickness acoustic panel B.Fill 50mm thickness 32kg/m³ acoustic cotton C.50mm Back Space

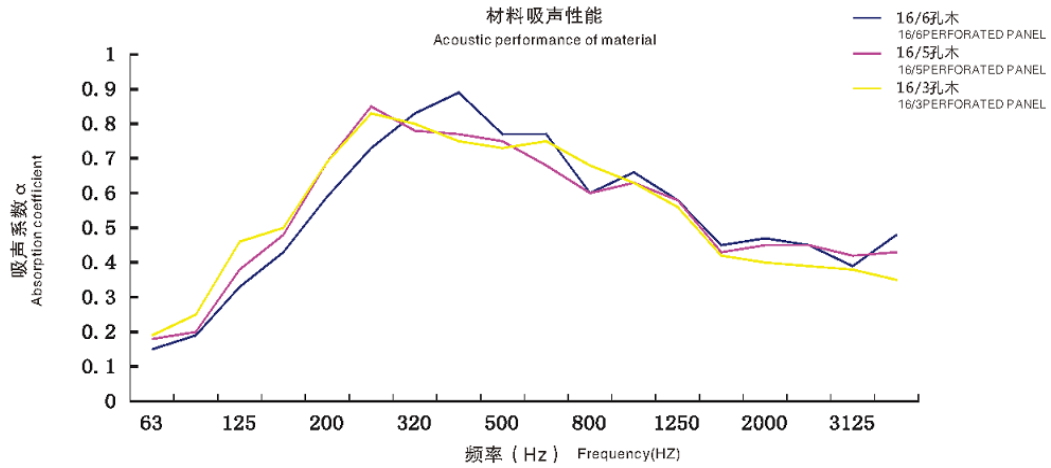

频率 (Hz)	63	100	125	160	200	250	320	400	500	630	800	1000	1250	1600	2000	2500	3125	3150
16/6孔木 α	0.15	0.19	0.33	0.43	0.69	0.73	0.83	0.89	0.77	0.77	0.6	0.66	0.58	0.45	0.47	0.45	0.39	0.66
16/5孔木 α	0.18	0.2	0.38	0.48	0.69	0.85	0.78	0.77	0.75	0.68	0.6	0.63	0.58	0.43	0.45	0.45	0.42	0.67
16/3孔木 α	0.19	0.25	0.46	0.5	0.69	0.83	0.8	0.75	0.73	0.75	0.68	0.63	0.56	0.42	0.4	0.39	0.38	0.62

Installation method:

Acoustic panel installation method for wall:

1. Fix the aluminium profile on to the wooden frame or bottom board, and their distance is suggested 600mm.
 2. Fill 32~64 kg/m³ density acoustic foam between each two profiles.
 3. Install the clips between the keel and the clip slot of acoustic panel.
 4. When install several acoustic panel, the distance between noses to noses is suggested 2~3 mm.
 5. If install in horizontal way, the notch should be installed downward and lock by clips.
- Then install the acoustic panel one by one.

INSTALLATION KEEL

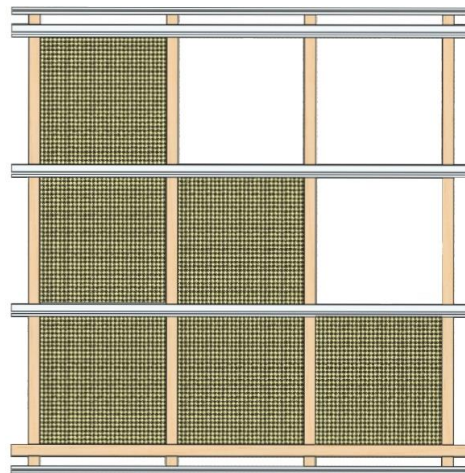
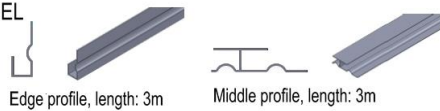

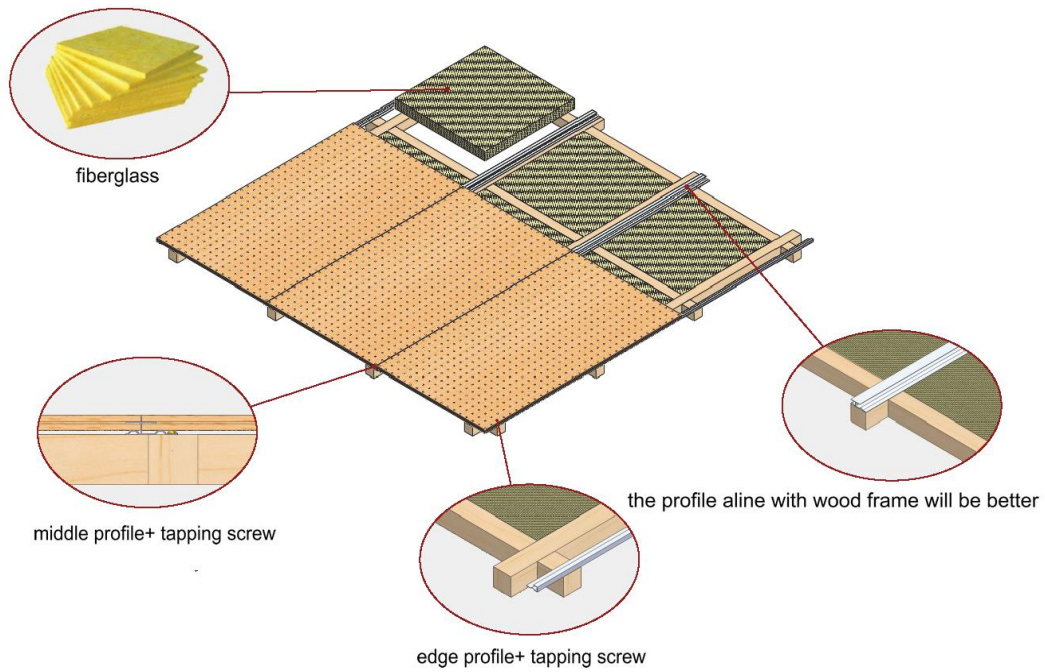

Application place:

Stadium, Auditorium, Multifunction room, Meeting room, Studio or any other place where seek for high acoustic requirements

Project Cases:

